

1 EROSION & SEDIMENT CONTROL- UPHILL CONDITION
SINGLE FAMILY HOME LOT #64

SCALE: 1"=20'

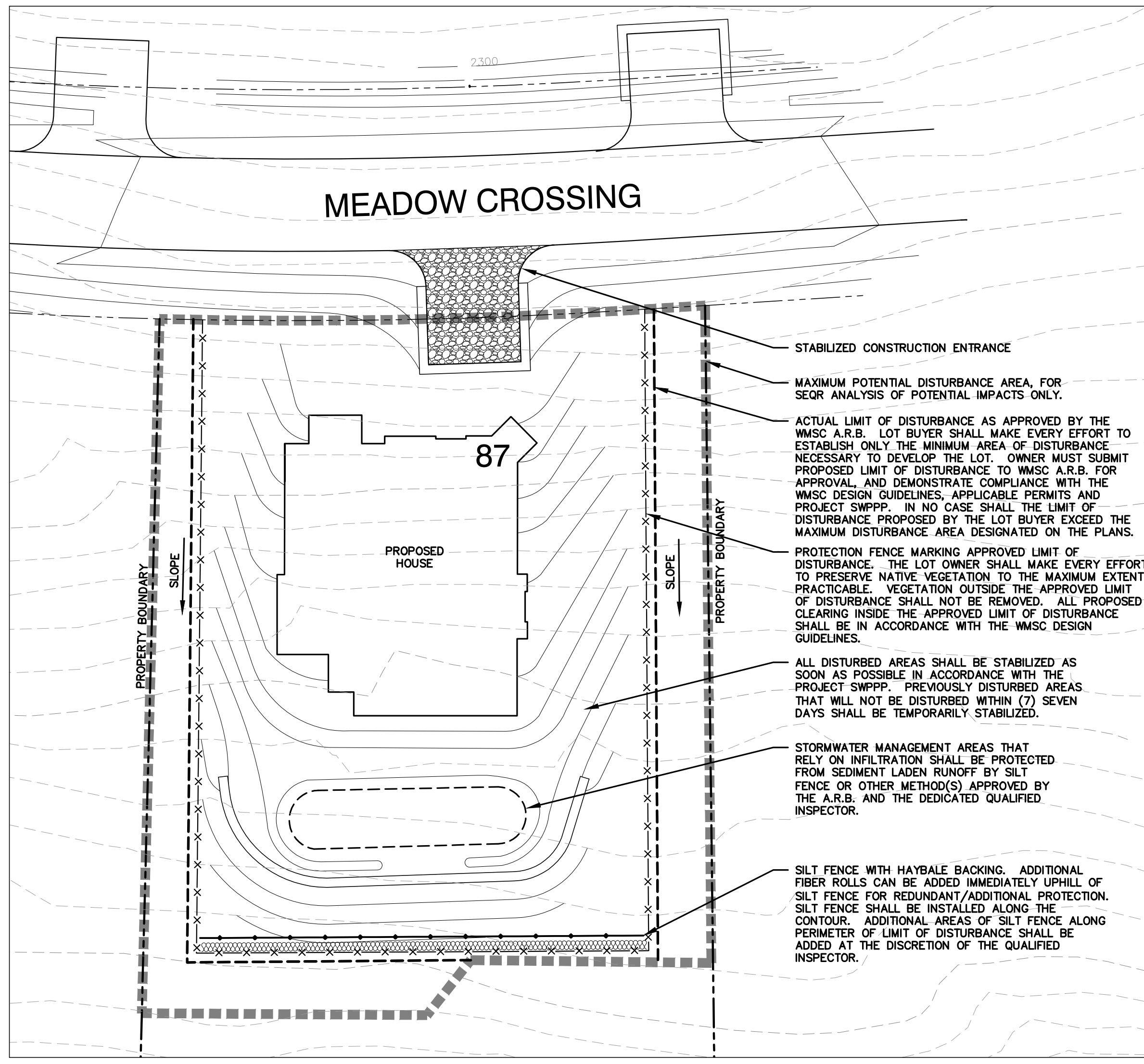

2 EROSION & SEDIMENT CONTROL- DOWNHILL CONDITION
SINGLE FAMILY HOME LOT #87

SCALE: 1"=20'

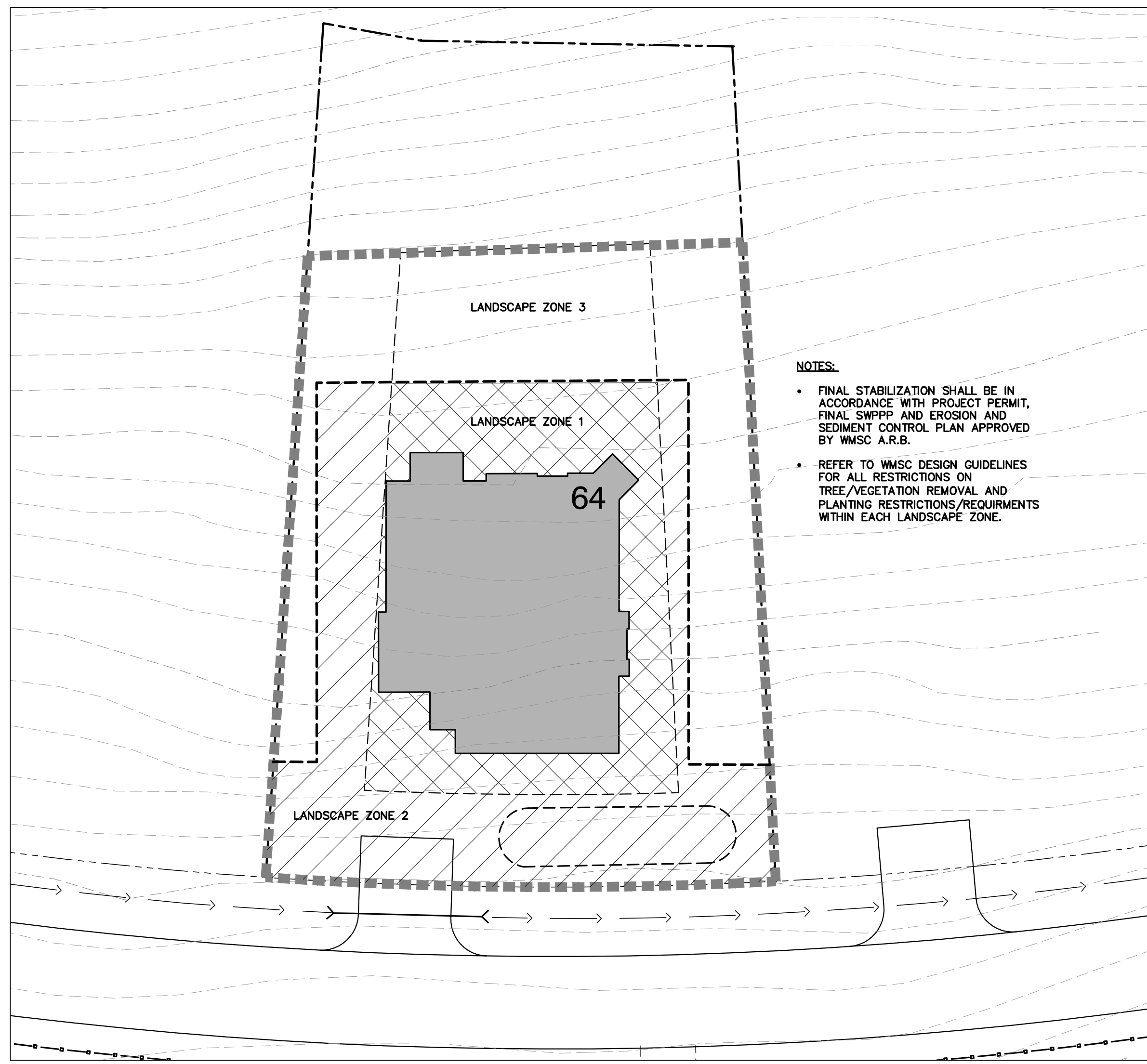

3 LANDSCAPE ZONES/STABILIZATION PLAN- UPHILL CONDITION
SINGLE FAMILY HOME LOT #64

SCALE: 1"=20'

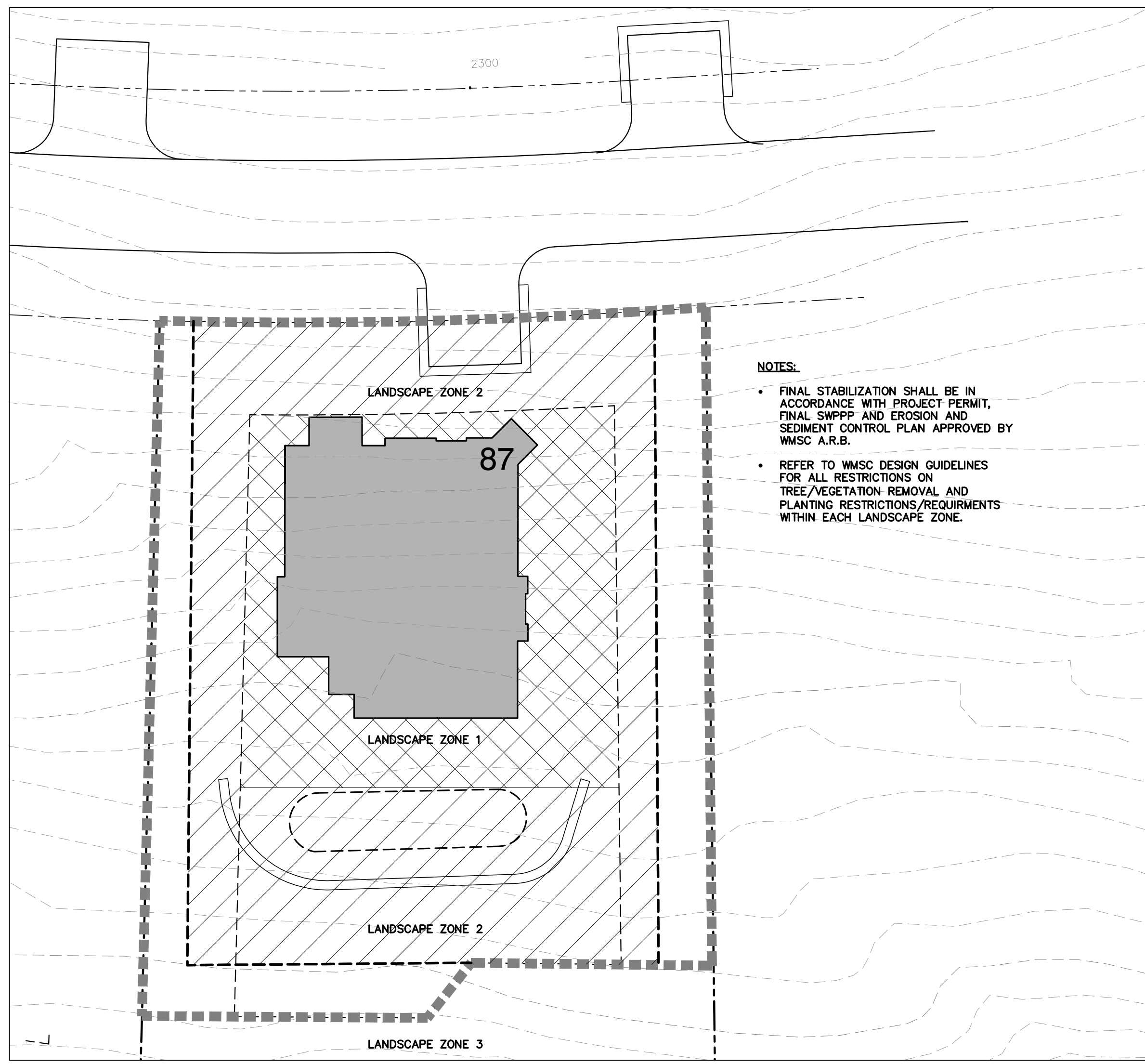

4 LANDSCAPE ZONES/STABILIZATION PLAN- DOWNHILL CONDITION
SINGLE FAMILY HOME LOT #87

SCALE: 1"=20'

GENERAL NOTES

- THE PURPOSE OF THESE PLANS IS TO SHOW A GENERAL APPROACH TO EROSION AND SEDIMENT CONTROL ON TYPICAL SINGLE FAMILY HOME LOTS, AND SET FORTH TYPICAL CONSTRUCTION SEQUENCING.
- A FINAL EROSION AND SEDIMENT CONTROL PLAN FOR EACH LOT MUST BE PREPARED BY A LICENSED PROFESSIONAL IN ACCORDANCE WITH NYS STANDARDS AND SPECIFICATIONS FOR EROSION AND SEDIMENT CONTROL, HEIGHTENED EROSION AND SEDIMENT CONTROLS IDENTIFIED IN THE PROJECT SWPPP, NYSDEC/NYSDP PERMIT REQUIREMENTS AND THE WMSC PROJECT DESIGN GUIDELINES.
- THE FINAL PLAN MUST BE APPROVED BY THE WINDHAM MOUNTAIN SPORTING CLUB (WMSC) ARCHITECTURAL REVIEW BOARD (A.R.B.), AND NOTIFICATION OF APPROVAL AND CONFORMANCE WITH THE FINAL PERMIT PROJECT SWPPP MUST BE PROVIDED TO NYSDEC, NYSDP AND THE TOWN OF WINDHAM CODE ENFORCEMENT OFFICER PRIOR TO CONSTRUCTION.
- PRIOR TO CONSTRUCTION THE GENERAL CONTRACTOR, DEDICATED EROSION AND SEDIMENT CONTROL CONTRACTOR, DEDICATED QUALIFIED INSPECTOR AND REPRESENTATIVE FROM THE WMSC A.R.B. SHALL MEET ON SITE TO REVIEW SPECIFIC PERMIT REQUIREMENTS AND THE STORMWATER POLLUTION PREVENTION PLAN (SWPPP).
- ONCE CONSTRUCTION BEGINS, ANY PROPOSED FIELD CHANGES TO THE FINAL APPROVED EROSION AND SEDIMENT CONTROL PLAN MUST BE DOCUMENTED AND APPROVED IN ACCORDANCE WITH THE FINAL SWPPP AND RELEVANT PERMIT CONDITIONS.

TYPICAL EROSION AND SEDIMENT CONTROL SEQUENCING

- CONSTRUCTION ON EACH LOT SHALL TYPICALLY PROCEED IN THE FOLLOWING SEQUENCE. A FINAL SEQUENCING PLAN SHALL BE INCLUDED AS PART OF THE FINAL EROSION AND SEDIMENT CONTROL PLAN SUBMITTED TO THE WMSC A.R.B. FOR REVIEW AND APPROVAL PRIOR TO CONSTRUCTION, AND SHALL CONFORM WITH ALL PROJECT PERMIT AND SWPPP REQUIREMENTS. ALL EROSION AND SEDIMENT CONTROL PRACTICES SHALL BE IMPLEMENTED IN STRICT ACCORDANCE WITH THE PROJECT STORMWATER POLLUTION PREVENTION PLAN AND PROJECT DETAILS.
- PRE-CONSTRUCTION AND SITE PREPARATION**
- PRE-CONSTRUCTION MEETING - DEFINE INSPECTION SCHEDULE, CONSTRUCTION STAGING, REVIEW STORMWATER POLLUTION PREVENTION PLAN AND PERMIT REQUIREMENTS.
 - STAKEOUT APPROVED LIMITS OF DISTURBANCE, CLEARING LIMITS, AREAS TO BE PROTECTED AND OTHER RELEVANT PROJECT COMPONENTS IN ACCORDANCE WITH THE WMSC DESIGN GUIDELINES.
 - INSTALL PROTECTION FENCE AROUND VEGETATION AND SENSITIVE ENVIRONMENTAL AREAS TO REMAIN UNDISTURBED.
 - INSTALL STABILIZED CONSTRUCTION ENTRANCES AND INITIAL STAGING AREAS AS SPECIFIED.
 - CUT AND REMOVE EXISTING TREES AND LOGS, DO NOT GRUB STUMPS.
- TEMPORARY RUNOFF AND DRAINAGE CONTROL**
- INSTALL PERIMETER EROSION CONTROL INCLUDING SILT FENCE, FIBER ROLLS, ETC., AND INLET PROTECTION AT EXISTING CULVERTS IF APPLICABLE.
 - IDENTIFY STAGE LOCATION OF STORMWATER MANAGEMENT AREAS. IF INFILTRATION PRACTICE IS USED, PROTECT FROM COMPACTION AND/OR SEDIMENTATION AT ALL TIMES.
 - INSTALL EROSION CONTROL TO PROTECT EXISTING ADJACENT STORMWATER MANAGEMENT SYSTEM COMPONENTS IF APPLICABLE.
 - INSTALL UPHILL FLOW CONTROL AND/OR DIVERSION IF REQUIRED.
 - INSTALL TEMPORARY CULVERTS INCLUDING INLET AND OUTLET PROTECTION, AND PERMANENT CULVERTS WHERE APPROPRIATE.
- EARTHWORK AND SITE CONSTRUCTION**
- GRUB STUMPS, ESTABLISH AND STABILIZE CONSTRUCTION STAGING AREAS.
 - TEMPORARILY STABILIZE CLEARED AREAS NOT TO BE DISTURBED WITHIN (7) SEVEN DAYS.
 - BEGIN ROCK REMOVAL EXCAVATION AND ROUGH GRADING.
 - IF SOIL STOCKPILES ARE NECESSARY, ENCLOSE DOWNHILL PERIMETER WITH SILT FENCE AND TEMPORARILY STABILIZE IF IT WILL REMAIN UNDISTURBED FOR MORE THAN (7) SEVEN DAYS.
 - BACKFILL FOUNDATION EXCAVATION, AND SPREAD EXCESS FILL MATERIAL ACROSS SITE AS SOON AS POSSIBLE TO ESTABLISH ROUGH GRADE.
 - INSTALL UTILITY INFRASTRUCTURE AS REQUIRED.
 - INSTALL TEMPORARILY EROSION AND SEDIMENT CONTROL DEVICES AND CONSTRUCTION STAGING AREAS.
- TEMPORARY STABILIZATION OF WORK AREA**
- STABILIZE ALL BARE SOIL AREAS TO REMAIN UNDISTURBED FOR MORE THAN (7) SEVEN DAYS. METHODS SUCH AS SEED AND MULCH, ROLLED EROSION CONTROL PRODUCT, OR A HYDROSEED MIXTURE OF WOOD FIBER MULCH WITH TACKIFYING AGENT, SHALL BE APPLIED IN STRICT ACCORDANCE WITH THE STORMWATER POLLUTION PREVENTION PLAN.
 - WHEN RAIN IS FORECASTED, TEMPORARILY STABILIZE ALL DISTURBED AREAS AT THE END OF EACH WORK DAY IN ACCORDANCE WITH THE S.W.P.P.P., OR AS DIRECTED BY QUALIFIED INSPECTOR.
 - INSPECT ALL PERIMETER EROSION CONTROL AND REPAIR AS DIRECTED.
 - INSPECT/REPAIR/REPLACE ALL EROSION AND SEDIMENT CONTROL DEVICES, STABILIZED AREAS AND CONSTRUCTION STAGING AREAS.
- PERMANENT STABILIZATION**
- ONCE SITE IS TEMPORARILY STABILIZED, OR AS DIRECTED BY QUALIFIED INSPECTOR, INSTALL STORMWATER MANAGEMENT DEVICES, CONVEYANCE MEASURES AND STABILIZE ALL INLETS, OUTLETS/CONVEYANCES.
 - STABILIZE ALL REMAINING DISTURBED AREAS. METHODS SUCH AS SOIL, SEED AND MULCH, ROLLED EROSION CONTROL PRODUCT, AND/OR A HYDROSEED MIXTURE OF WOOD FIBER MULCH WITH TACKIFYING AGENT ON SLOPES GREATER THAN 3:1, SHALL BE APPLIED IN STRICT ACCORDANCE WITH THE STORMWATER POLLUTION PREVENTION PLAN, OR AS DIRECTED BY THE QUALIFIED INSPECTOR.
 - PAVE DRIVEWAYS, INSTALL PROPOSED PLANT MATERIALS.
 - REPAIR / RE-STABILIZE AREAS AS NEEDED.
 - RECEIVE CERTIFICATION OF STABILIZATION FROM QUALIFIED INSPECTOR.
 - CLEAN ALL STORMWATER SYSTEMS OF SEDIMENT, TRASH, AND DEBRIS.
 - REMOVE TEMPORARY EROSION AND SEDIMENT CONTROL MEASURES ONLY WHEN WORK AREAS ARE APPROVED AS STABILIZED BY THE QUALIFIED INSPECTOR.

Drawing File: 080777333.dwg
 Plot File Name: 080777333.dwg
 File Name: 080777333.dwg
 User: Windham08077333.dwg
 Date: 6/20/2014 10:00:00 AM
 Plot Date: 6/20/2014 10:00:00 AM
 Plot File Name: 080777333.dwg