

MATCH LINE PN12
MATCH LINE PN13

MATCH LINE PN12
MATCH LINE PN13

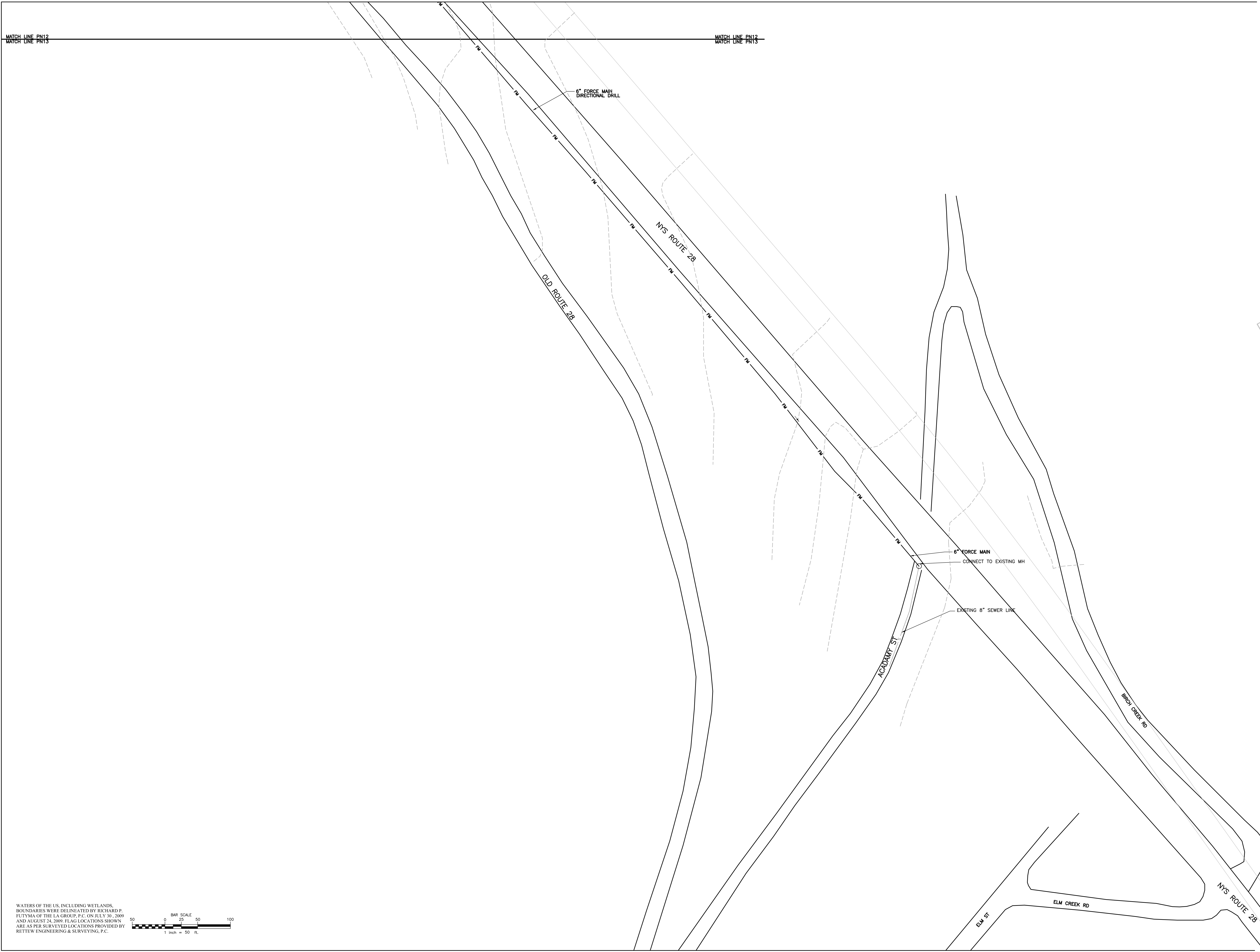

WATERS OF THE US, INCLUDING WETLANDS, BOUNDARIES WERE DELINEATED BY RICHARD P. FUYTMA OF THE LA GROUP, P.C. ON JULY 30, 2009 AND AUGUST 24, 2009. FLAG LOCATIONS SHOWN ARE AS PER SURVEYED LOCATIONS PROVIDED BY RETTEW ENGINEERING & SURVEYING, P.C.

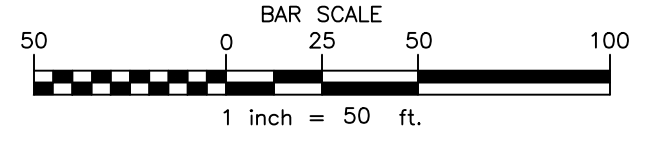

the LA group
Landscape Architecture
and Engineering, PC
40 Long Alley
Saratoga Springs
New York 12866
P 518/587-8100
F 518/587-0180
www.thelagroup.com

Unauthorized alteration or addition to this document is a violation of Section 7209 of the New York State Education Law

© the LA Group 2010

Design _____
Drawn _____
Checked _____

This drawing is not certified for the purposes of construction, unless it is specifically noted as issued for construction.

Submission:
FOR REGULATORY APPROVALS ONLY

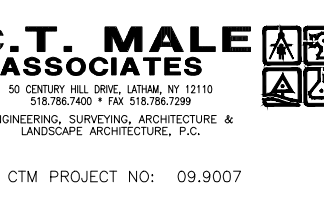

CTM PROJECT NO. 09.007

PREPARED FOR:
Crossroads Ventures, L.L.C.
PO Box 267
Mt. Tremper, NY 12457

The Modified Belleayre Resort at Catskill Park
Wildacres Resort & The Highmount Spa Resort
Town of Shandaken & Town of Middletown, New York
PRELIMINARY WATER AND SEWER DESIGN

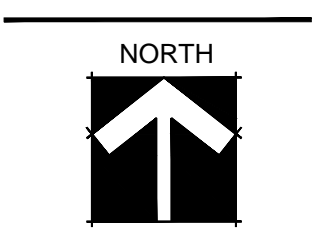
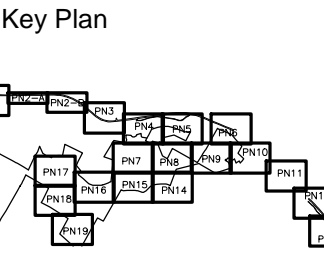

Revisions

Project: 07074
Date: _____

Drawing
PN13