

INSET

MATCHLINE - SEE INSET AT LEFT

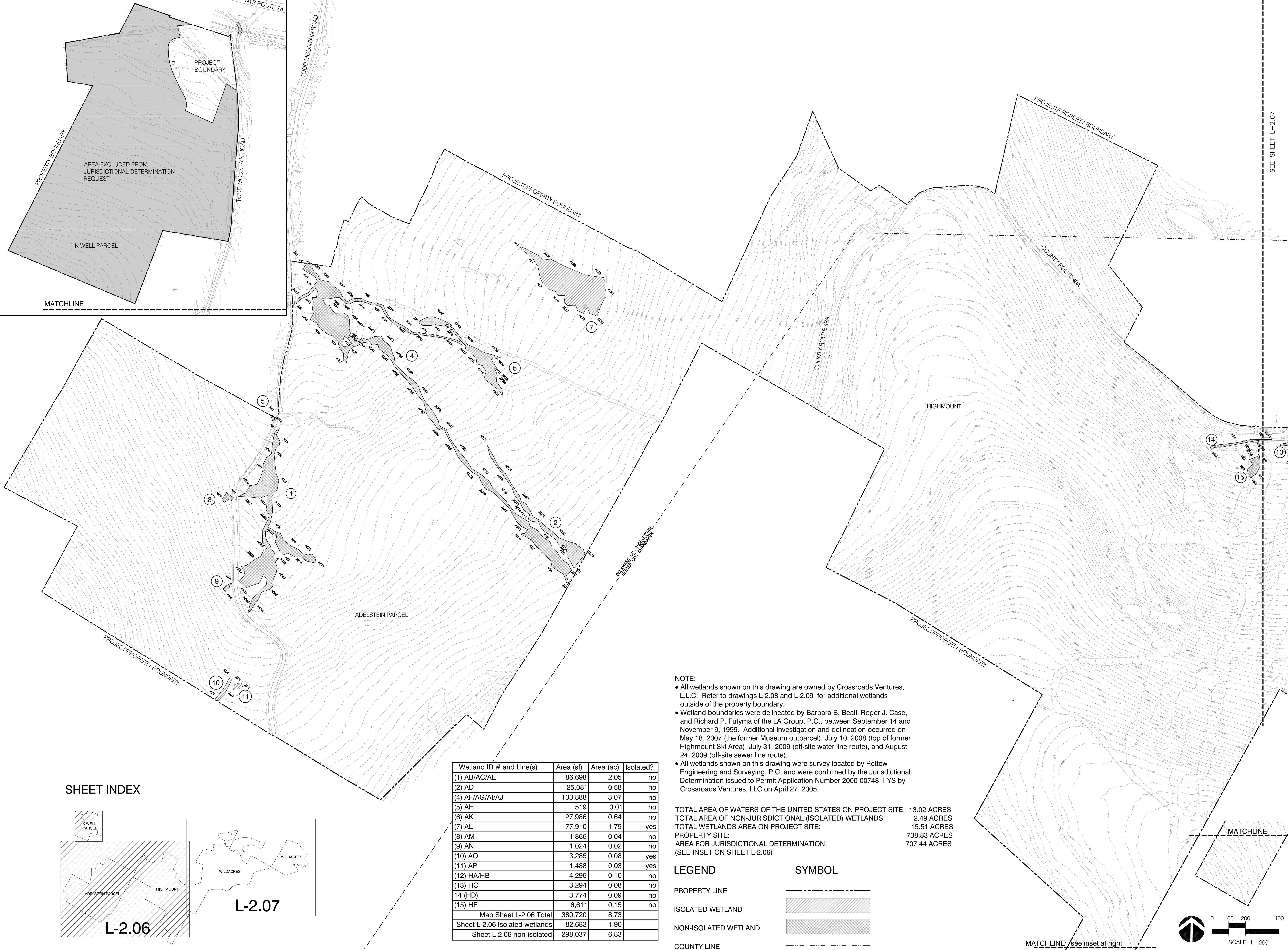

- NOTE:
- All wetlands shown on this drawing are owned by Crossroads Ventures, L.L.C. Refer to drawings L-2.08 and L-2.09 for additional wetlands outside of the property boundary.
 - Wetland boundaries were delineated by Barbara B. Beall, Roger J. Case, and Richard P. Futyma of the LA Group, P.C., between September 14 and November 9, 1999. Additional investigation and delineation occurred on May 18, 2007 (the former Museum outparcel), July 10, 2008 (top of former Highmount Ski Area), July 31, 2009 (off-site water line route), and August 24, 2009 (off-site sewer line route).
 - All wetlands shown on this drawing were survey located by Rettew Engineering and Surveying, P.C. and were confirmed by the Jurisdictional Determination issued to Permit Application Number 2000-00748-1-YS by Crossroads Ventures, LLC on April 27, 2005.

TOTAL AREA OF WATERS OF THE UNITED STATES ON PROJECT SITE: 13.02 ACRES
TOTAL AREA OF NON-JURISDICTIONAL (ISOLATED) WETLANDS: 2.49 ACRES
TOTAL WETLANDS AREA ON PROJECT SITE: 15.51 ACRES
PROPERTY SITE: 738.83 ACRES
AREA FOR JURISDICTIONAL DETERMINATION: 707.44 ACRES
(SEE INSET ON SHEET L-2.06)

LEGEND	SYMBOL
PROPERTY LINE	---
ISOLATED WETLAND	
NON-ISOLATED WETLAND	
COUNTY LINE	---

MATCHLINE: see inset at right

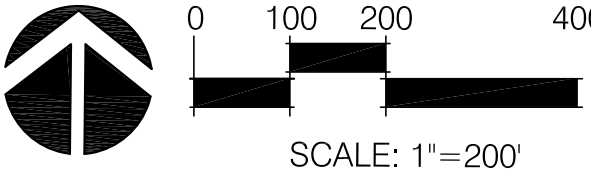

SHEET INDEX

